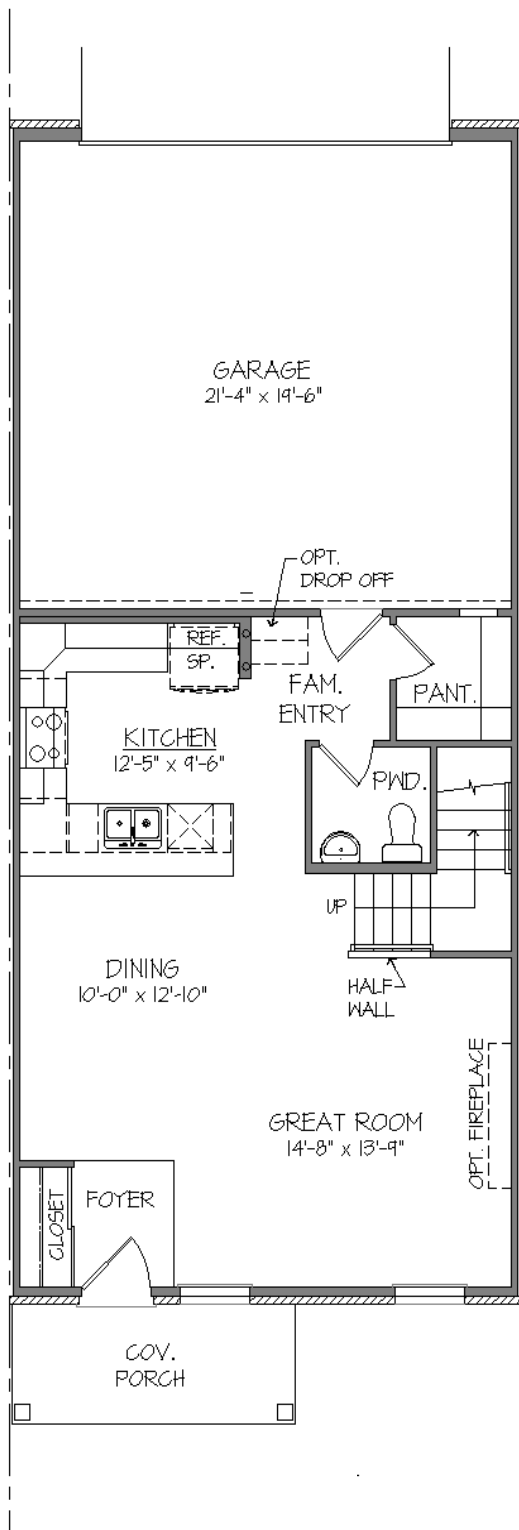
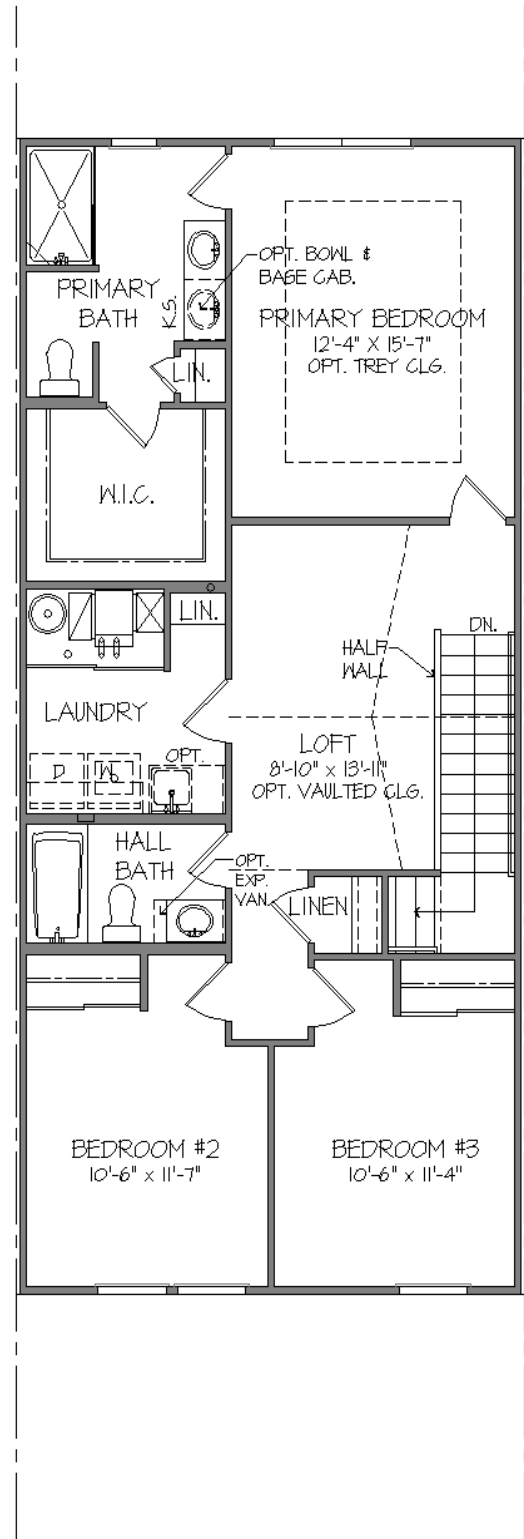

THE GEORGETOWN

1,739 Sq. Ft. | 3 Bedrooms | Loft | 2.5 Baths

**FIRST FLOOR PLAN****SECOND FLOOR PLAN**

THE GEORGETOWN | OPTIONS

1,739 Sq. Ft. | 3 Bedrooms | Loft | 2.5 Baths

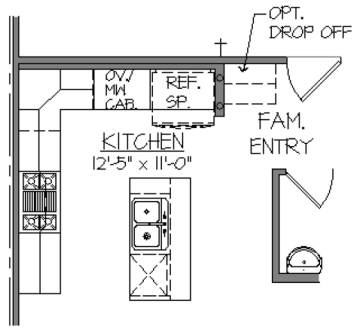

Luxury Kitchen with
Built-Ins

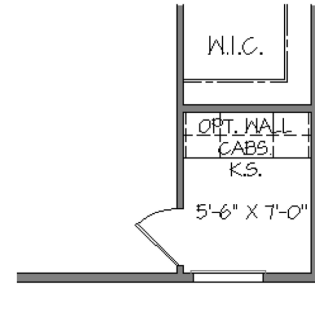

Virtual Office

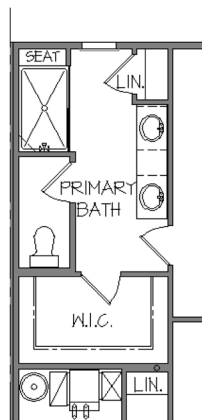

Primary Bath with
Shower Only

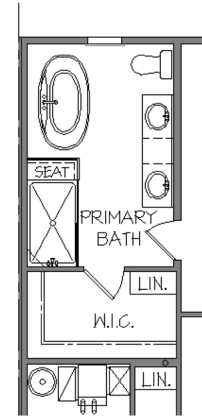

Primary Bath with
Freestanding Tub

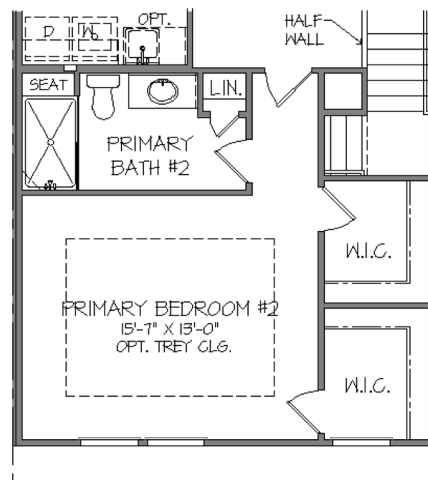

Opt. 2nd Floor with 2nd
Primary Bedroom

Rev. 8/14/25. This depiction represents an artist's conception of the elevation and floor plan and is not intended to be an exact representation or show specific detailing. Plans remain subject to change without notice. Drawings are not to scale. All measurements shown are approximate and not necessarily to scale. Location, size and construction of doors, windows, wall, fireplaces and any other items depicted may vary depending on elevation preference or choice of options and are subject to change without notice. Some options and elevations shown may not be available in every neighborhood; see Sales Manager for details. Due to normal construction tolerances, the room sizes shown may vary slightly. The Builder may change home design, materials, features and methods of construction without prior notice. Model homes may contain some optional features not available through the Builder.